



ECOSOFT
MEMBRANE

DOW Filmtec® membrane sheet

no components are released into treated water - safe chemical composition of membrane sheet confirmed by NSF certificate

Tasty water

Quality of treated water confirmed by NSF certificate for membrane sheet

High salt rejection – 97%

Confirmed by NSF certificate for membrane sheet

100% quality control

Each membrane element is vacuum tested



Fast



POWER OF
PURITY
ecosoft.com

20% higher flow rate

Compared to the membranes of other manufacturers at the same pressure

20 minutes faster tank filling

Always enough water, even at peak demand



Full capacity even with cold water

50 GPD even at 15 °C

R&D data

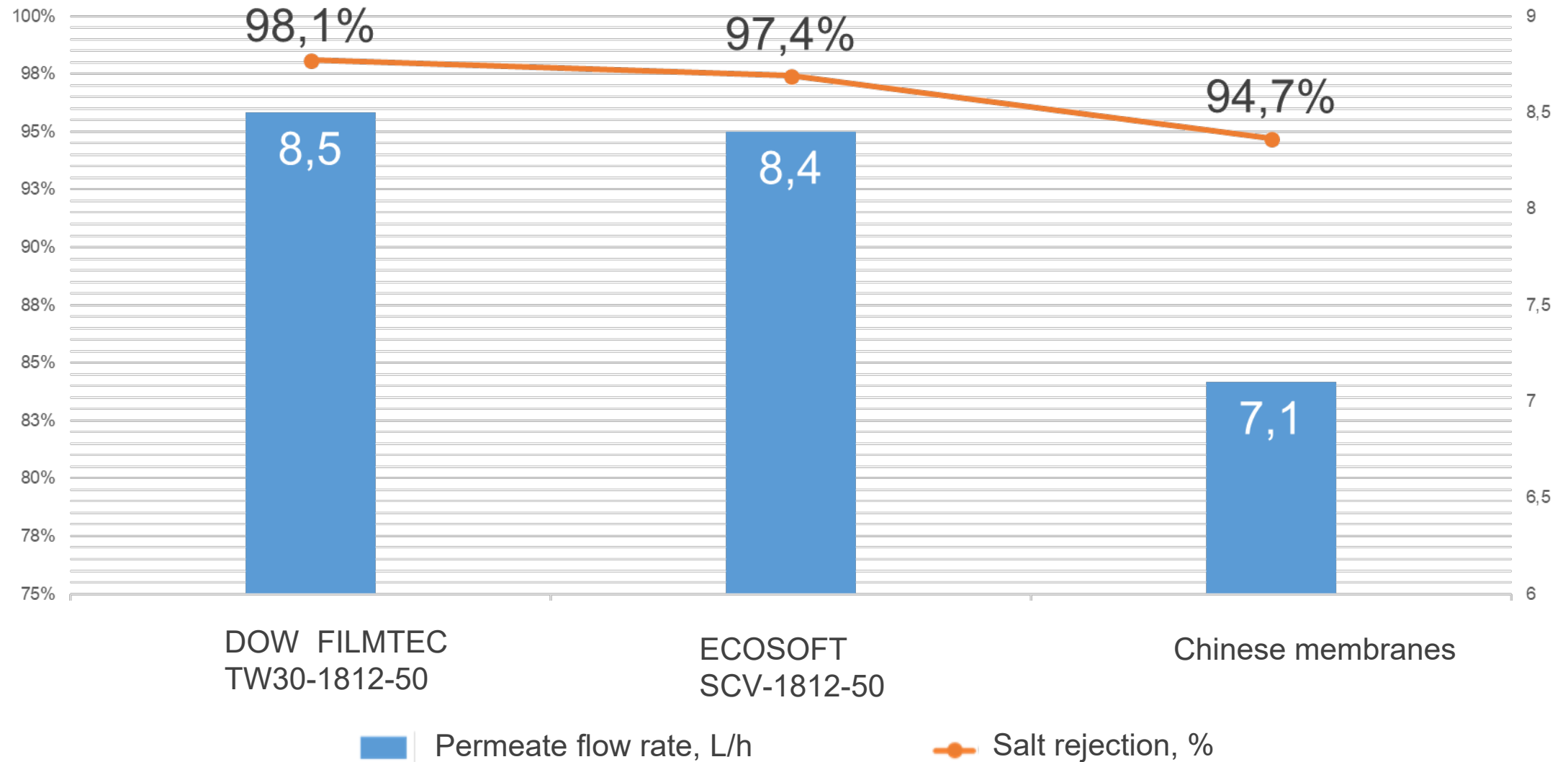

Time of tank filling, min



DOW Filmtec
TW1812-50



48 min

Ecosoft
CSV1812-50



52 min

NoName
1812-50



72 min

Reliable



POWER OF
PURITY
ecosoft.com

Works for 1000 ppm TDS concentration

DOW Filmtec membrane sheet can deal with complex water with high TDS content

Extended service life

Resistant to the fouling thanks to the higher spacer thickness of 0.68 mm (26 mil), while other membranes have spacer of 0.43 mm (16 mil)



Market Participants



POWER OF
PURITY
ecosoft.com

Parameter	DOW Filmtec	Ecosoft	No Name
Safe and tasty			
Manufacturer of membrane sheet	DOW Filmtec CША	DOW Filmtec CША	China
Production line	automated	automated	manual
Rejection, declared/real	98.0 / 98.1	97.0 / 97.4	97.5 / 94.7
Rejection, declared/real	98.0 / 98.1	97.0 / 97.4	97.5 / 94.7
Fast			
Flow rate / pressure	50 / 3.4	50 / 3.4	50 / 4.1
Tank filling time	48	52	72
Flow rate for cold water	50 GPD at 15 °C	50 GPD at 15 °C	35 GPD at 15 °C
More			
Resistance to fouling	up to 1 000 ppm	up to 1 000 ppm	up to 500 ppm
List Price, EUR	29	20	16

THE TECHNICAL DATA

TECHNICAL DATA AND OPERATIONAL PARAMETERS

Code	Element Type	Average permeate flow rate, L/h (GPD)	Stabilized Salt Rejection, %	Applied pressure, bar (psi)
CSV181250ECO	50 GPD	7.9 (50)	97.0	3.4 (50)
CSV181275ECO	75 GPD	12.0 (75)	97.0	3.4 (50)
CSV1812100ECO	100 GPD	15.8 (100)	97.0	3.4 (50)

1. Permeate flow and salt rejection based on the following test conditions: 250 ppm softened tap water, 25 °C (77 °F), 15% recovery and the specified applied pressure
2. Minimum salt rejection is 95%
3. Permeate flow for individual elements for warranty evaluation may vary $\pm 20\%$

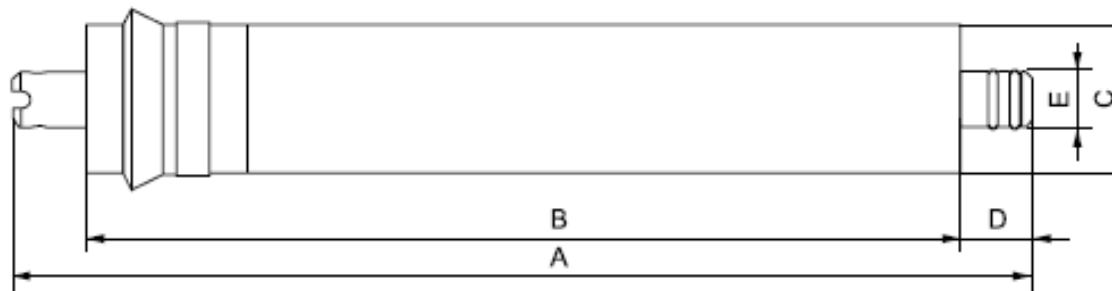

MEMBRANE ELEMENTS DIMENSIONS

Element Type	A	B	C	D	E
50 GPD			Ø		Ø
75 GPD	297±1 mm (11.73")	235±2 mm (9.25")	45±2 mm (1.775±0.07")	22±2 mm (0.87")	17±0,3 mm (0.67")
100 GPD					

Thank for Your Attention



POWER
OF PURITY
ecosoft.com
